

1
2
3
4
5
6
7
8
9
10
11
12
13
14
15
16
17
18
19
20
21
22
23
24
25
26
27
28

BILL NO. 2006-13

ORDINANCE NO. _____

AN ORDINANCE TO EXTEND THE BOUNDARIES OF THE CITY, TO PARTICULARLY DESCRIBE THE LAND TO BE ANNEXED, TO MAKE ITS INHABITANTS SUBJECT TO THE LAWS, OBLIGATIONS AND BENEFITS OF THE CITY, AND TO PROVIDE FOR OTHER RELATED MATTERS. (ANX-10579)

Sponsored by:
Councilman Lawrence Weekly

Summary: Annexes property described generally as located on the southeast corner of Roberta Lane and Apricot Lane.

THE CITY COUNCIL OF THE CITY OF LAS VEGAS DOES HEREBY
ORDAIN AS FOLLOWS:

SECTION 1: The corporate limits of the City of Las Vegas, Nevada, are hereby extended to annex, include, and make a part of the City of Las Vegas, Nevada, the following described real property:

That portion of the Southwest Quarter (SW 1/4) of the Southeast Quarter (SE 1/4) of Section 13, Township 20 South, Range 60 East, M.D.M., in the County of Clark, State of Nevada, described as follows:

COMMENCING at the northeast corner of the southeast Quarter (SE 1/4) of the Southeast Quarter (SE 1/4) of said Section 13, also being the centerline intersection of DECATUR BOULEVARD (60.00 feet wide as measured from centerline thereof) and ROBERTA LANE (30.00 feet wide as measured from centerline thereof); thence along the centerline of ROBERTA LANE, as shown on Record of Survey in File 109, Page 20 of Clark County, Nevada Records, North 87°46'19" West 960.82 feet; thence continuing along said centerline, North 87°27'16" West 30.00 feet; thence North 87°27'19" West 329.29 feet to the POINT OF BEGINNING; thence departing the centerline of said ROBERTA LANE, along the west line of LOT 4 as shown on Parcel Map in File 53, Page 63 of Clark County, Nevada Records, South 02°37'01" West 356.98 feet to the northeast corner of LOT 1 as shown on Parcel Map in File 69, Page 21 of Clark County, Nevada Records; thence along the north

1 line of said LOT 1 and the westerly projection, North 87°32'26" West 330.00
2 feet to the centerline of APRICOT LANE (30.00 feet wide as measured from
3 centerline thereof); thence along the centerline of said APRICOT LANE,
4 North 02°37'01" East 361.76 feet to the centerline of ROBERTA LANE;
5 thence along the centerline of said ROBERTA LANE, South 87°29'23" East
6 330.00 feet; thence South 02°30'55" West 4.51 feet to the POINT OF
7 BEGINNING.

8 THE BASIS OF BEARINGS: North 05°32'17" West, being the centerline of
9 MICHAEL WAY as shown on Record of Survey in file 87, page 10 of Clark
10 County, Nevada Records.

11 Prepared by:
12 Brian Yu PLS
13 Public Works, City of Las Vegas,
14 731 South. Fourth Street,
15 Las Vegas, NV 89101

16 SECTION 2: The City Council hereby determines that the described territory
17 meets the requirements provided by law for annexation to the City for the following reasons:

- 18 A. The area to be annexed was contiguous to the City's boundaries at the
19 time the annexation proceedings were instituted;
- 20 B. More than one-eighth (1/8) of the aggregate external boundaries of
21 the area are contiguous to the City;
- 22 C. The territory proposed to be annexed is not included within the
23 boundaries of another incorporated city or within the boundaries of
24 any unincorporated town as those boundaries existed as of July 1,
25 1983;
- 26 D. The City is eligible to annex the described territory since the
27 landowners have signed a petition constituting one hundred percent
28 (100%) of the owners of record of individual lots or parcels of land
within the annexation area.

SECTION 3: The City will provide police protection through the Las Vegas
Metropolitan Police Department, fire protection, street maintenance, and library services
immediately upon annexation. Garbage collection by the company franchised by the City
will also be provided immediately. The City sanitary sewer system will serve the proposed
annexation area. Any connection to or extension of this sewer line to serve the annexation

1 area shall be at the expense of the landowners. Other services, such as participation in the
2 City's recreational programs, special education classes and programs, public works planning,
3 building inspections, and other City services will also be available immediately. Utilities
4 such as gas, electricity, telephone, and water are provided by private utility companies and
5 other services to the area will not be affected by annexation. Street paving, curbs and gutters,
6 sidewalks and street lights which are not in place at the time of annexation will be installed
7 in the presently developed areas upon the request of the property owners and at their expense
8 by means of special assessment districts. Such improvements will be extended into the
9 undeveloped areas as development takes place and the need therefor arises, and will be
10 located according to the needs of the area at that time. Such installations will also be made
11 at the expense of the property owners, either by means of special assessment districts or as
12 prerequisites to the approval of subdivision plats, building permits or other land use or
13 development applications.

14 SECTION 4: The annexation of the described territory shall become
15 effective on the 14th day of April, 2006, and on that date the City will have the funds
16 appropriated in sufficient amount to finance the extension into the described territory of
17 police protection, fire protection, street maintenance, street sweeping, and street lighting
18 maintenance.

19 SECTION 5: The described territory, together with the inhabitants and
20 property thereof, shall, from and after the 14th day of April, 2006, be subject to all debts,
21 laws, ordinances and regulations in force in the City and shall be entitled to the same
22 privileges and benefits as other parts of the City, and shall be subject to municipal taxes
23 levied by the City.

24 SECTION 6: The City Engineer is hereby instructed to cause to be prepared
25 an accurate map or plat of the described territory and to record the map or plat, together with
26 a certified copy of this ordinance, in the office of the County Recorder of Clark County,
27 Nevada, which recording shall be done prior to the 14th day of April, 2006.

28 SECTION 7: The described territory, which previously has been zoned R-E

1 (County of Clark classification), is hereby classified as U (R) (City of Las Vegas
2 classification), which is deemed to be the City equivalent of the County classification.

3 SECTION 8: If any section, subsection, subdivision, paragraph, sentence,
4 clause of phrase in this ordinance or any part thereof, is for any reason held to be
5 unconstitutional, or invalid or ineffective by any court of competent jurisdiction, such
6 decision shall not affect the validity or effectiveness of the remaining portions of this
7 ordinance or any part thereof. The City Council of the City of Las Vegas hereby declares that
8 it would have passed each section, subsection, subdivision, paragraph, sentence, clause or
9 phrase thereof irrespective of the fact that any one or more sections, subsections,
10 subdivisions, paragraphs, sentences, clauses or phrases be declared unconstitutional, invalid
11 or ineffective.

12 SECTION 9: All ordinances or parts of ordinances, sections, subsections,
13 phrases, sentences, clauses or paragraphs contained in the Municipal Code of the City of Las
14 Vegas, Nevada, 1983 Edition, in conflict herewith are hereby repealed.

15 PASSED, ADOPTED and APPROVED this ____ day of _____,
16 2006.

17 APPROVED:

18
19 By OSCAR B. GOODMAN, Mayor

20 ATTEST:

21
22 BARBARA JO RONEMUS, City Clerk

23 APPROVED AS TO FORM:

24 Val Steed 2-15-06
Date

1 The above and foregoing ordinance was first proposed and read by title to the Council on the
2 ____ day of _____, 2006, and referred to the following committee
3 composed of _____ and _____ for recommendation;
4 thereafter the said committee reported favorably on said ordinance on the ____ day of
5 _____, 2006, which was a _____ meeting of said Council; that
6 at said _____ meeting, the proposed ordinance was read by title to the City
7 Council as first introduced and adopted by the following vote:

8 VOTING "AYE": _____

9 VOTING "NAY": _____

10 ABSENT: _____

11 APPROVED:

12
13 By _____
14 OSCAR B. GOODMAN, Mayor

15 ATTEST:

16 _____
17 BARBARA JO RONEMUS, City Clerk
18
19
20
21
22
23
24
25
26
27
28

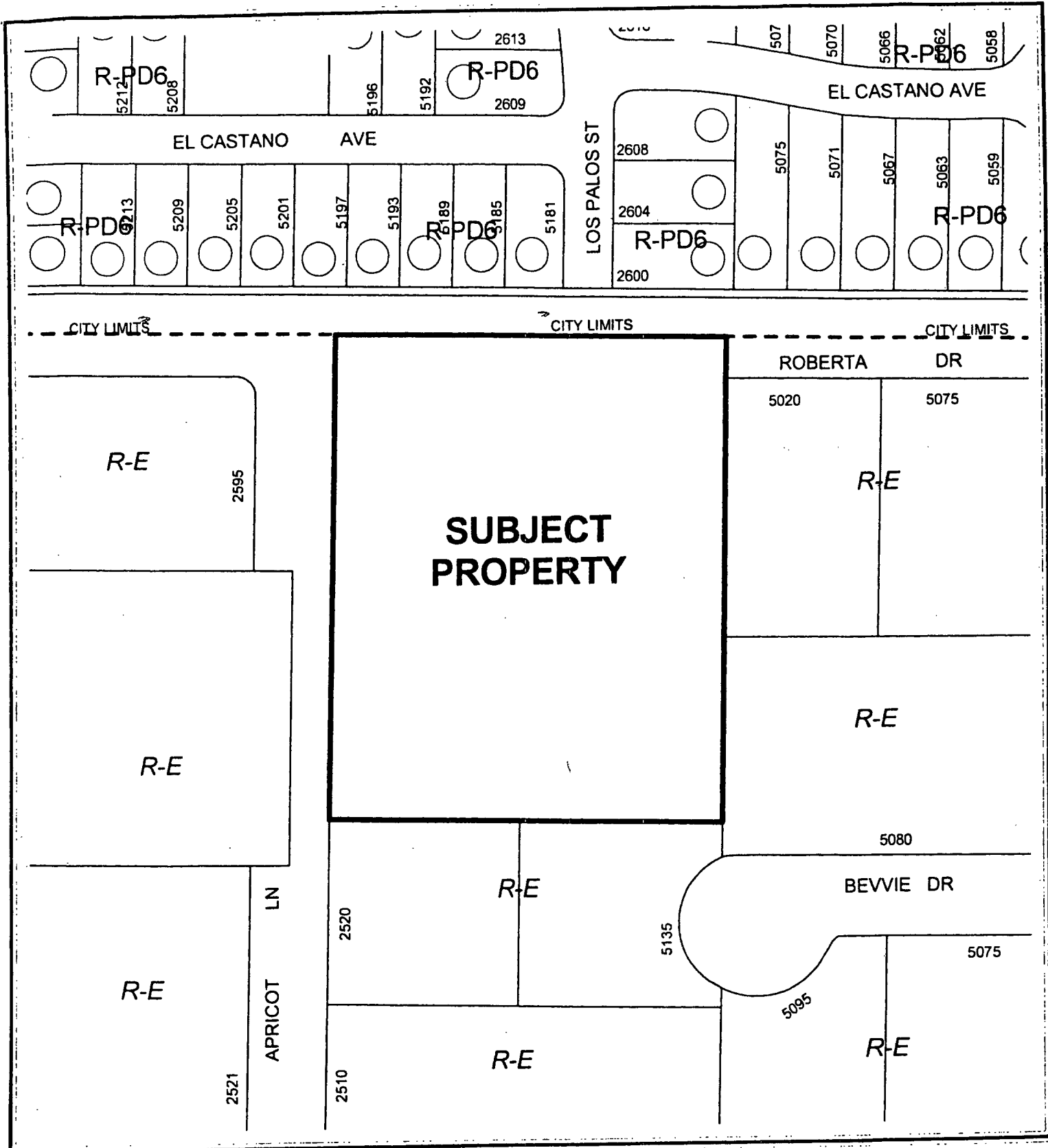

CASE: ANX-10579

