

1  
2  
3  
4  
5  
6  
7  
8  
9  
10  
11  
12  
13  
14  
15  
16  
17  
18  
19  
20  
21  
22  
23  
24  
25  
26  
27  
28

**BILL NO. 2006-15**

**ORDINANCE NO. \_\_\_\_\_**

AN ORDINANCE TO EXTEND THE BOUNDARIES OF THE CITY, TO PARTICULARLY DESCRIBE THE LAND TO BE ANNEXED, TO MAKE ITS INHABITANTS SUBJECT TO THE LAWS, OBLIGATIONS AND BENEFITS OF THE CITY, AND TO PROVIDE FOR OTHER RELATED MATTERS. (ANX-11001)

Sponsored by: Councilman Steven D. Ross Summary: Annexes property described generally as located on the west side of Coke Street, between Racel Street and Brent Lane.

THE CITY COUNCIL OF THE CITY OF LAS VEGAS DOES HEREBY ORDAIN AS FOLLOWS:

SECTION 1: The corporate limits of the City of Las Vegas, Nevada, are hereby extended to annex, include, and make a part of the City of Las Vegas, Nevada, the following described real property:

Those portions of the West Half (W 1/2) of the East Half (E 1/2) of the East Half (E 1/2) of Section 9, Township 19 South, Range 60 East, M.D.M., as shown on the Record of Survey in File 150, Page 3, of Clark County, Nevada Records, described as follows:

PARCEL 1

The West Half (W 1/2) of the Southwest Quarter (SW 1/4) of the Southeast Quarter (SE 1/4) of the Northeast Quarter (NE 1/4) of said Section 9.

PARCEL 2

COMMENCING at the southeast one sixteenth corner of said Section 9, said corner also being the centerline intersection of CONOUGH LANE (30.00 feet wide as measured from the centerline thereof) and RACEL STREET (30.00 feet wide as measured from the centerline thereof); thence along the west line of the Northeast Quarter (NE 1/4) of the Southeast Quarter (SE 1/4)

1 of said Section 9 and the centerline of said CONOUGH LANE, North  
2 00°16'31" West 350.01 feet to the POINT OF BEGINNING; thence  
3 continuing along said centerline, North 00°16'31" West 404.95 feet to the  
4 centerline of TEASHA AVENUE (30.00 feet wide as measured from the  
5 centerline thereof); thence continuing along the centerline of said  
6 CONOUGH LANE, North 00°16'31" West 377.66 feet to the northwest  
7 corner of the South Half (S 1/2) of the Northwest Quarter (NW 1/4) of the  
8 Northeast Quarter (NE 1/4) of the Southeast Quarter (SE 1/4) of said Section  
9 9; thence along the north line of said South Half (S 1/2), South 88°13'48"  
10 East 678.81 feet to the east line of said South Half (S 1/2) and the centerline  
11 of COKE STREET (30.00 feet wide as measured from the centerline thereof);  
12 thence along the centerline of said COKE STREET, South 00°19'40" East  
13 383.35 feet to the centerline of said TEASHA AVENUE; thence continuing  
14 along the centerline of said COKE STREET, South 00°21'57" East 531.50  
15 feet; thence along the easterly projection of the south line of LOT 1 as shown  
16 on Parcel Map in File 8, Page 56 of Clark County, Nevada Records, North  
17 85°57'51" West 444.43 feet to the east line of LOT 2 of said Parcel Map in  
18 File 8, Page 56; thence along the east line of said LOT 2, North 00°14'37"  
19 West 105.07 feet to the northeast corner of said LOT 2; thence along the  
20 north line and the westerly projection of said LOT 2, North 85°55'25" West  
21 237.14 feet to the POINT OF BEGINNING.

22 BASIS OF BEARINGS: South 89°23'29" East, being the bearing of the  
23 North line of the Southwest Quarter (SW 1/4) of the Northeast Quarter  
24 (NE 1/4) of the Northeast Quarter (NE 1/4) of Section 9, Township 19 South,  
25 Range 60 East, M.D.M., as shown by map on file in Book 118, Page 40 of  
26 Plats in Clark County, Nevada Records.

27 Prepared by:  
28 Brian Yu, PLS  
731 South Fourth Street,  
Public Works, City of Las Vegas,  
Las Vegas, NV 89101

SECTION 2: The City Council hereby determines that the described territory  
meets the requirements provided by law for annexation to the City for the following reasons:

- A. The area to be annexed was contiguous to the City's boundaries at the time the annexation proceedings were instituted;
- B. More than one-eighth (1/8) of the aggregate external boundaries of the area are contiguous to the City;
- C. The territory proposed to be annexed is not included within the boundaries of another incorporated city or within the boundaries of any unincorporated town as those boundaries existed as of July 1, 1983;
- D. The City is eligible to annex the described territory since the

1 landowners have signed a petition constituting one hundred percent  
2 (100%) of the owners of record of individual lots or parcels of land  
3 within the annexation area.

4 SECTION 3: The City will provide police protection through the Las Vegas  
5 Metropolitan Police Department, fire protection, street maintenance, and library services  
6 immediately upon annexation. Garbage collection by the company franchised by the City  
7 will also be provided immediately. The City sanitary sewer system will serve the proposed  
8 annexation area. Any connection to or extension of this sewer line to serve the annexation  
9 area shall be at the expense of the landowners. Other services, such as participation in the  
10 City's recreational programs, special education classes and programs, public works planning,  
11 building inspections, and other City services will also be available immediately. Utilities  
12 such as gas, electricity, telephone, and water are provided by private utility companies and  
13 other services to the area will not be affected by annexation. Street paving, curbs and gutters,  
14 sidewalks and street lights which are not in place at the time of annexation will be installed  
15 in the presently developed areas upon the request of the property owners and at their expense  
16 by means of special assessment districts. Such improvements will be extended into the  
17 undeveloped areas as development takes place and the need therefor arises, and will be  
18 located according to the needs of the area at that time. Such installations will also be made  
19 at the expense of the property owners, either by means of special assessment districts or as  
20 prerequisites to the approval of subdivision plats, building permits or other land use or  
21 development applications.

22 SECTION 4: The annexation of the described territory shall become  
23 effective on the 28th day of April, 2006, and on that date the City will have the funds  
24 appropriated in sufficient amount to finance the extension into the described territory of  
25 police protection, fire protection, street maintenance, street sweeping, and street lighting  
26 maintenance.

27 SECTION 5: The described territory, together with the inhabitants and  
28 property thereof, shall, from and after the 28th day of April, 2006, be subject to all debts,

1 laws, ordinances and regulations in force in the City and shall be entitled to the same  
2 privileges and benefits as other parts of the City, and shall be subject to municipal taxes  
3 levied by the City.

4 SECTION 6: The City Engineer is hereby instructed to cause to be prepared  
5 an accurate map or plat of the described territory and to record the map or plat, together with  
6 a certified copy of this ordinance, in the office of the County Recorder of Clark County,  
7 Nevada, which recording shall be done prior to the 28th day of April, 2006.

8 SECTION 7: The described territory, which previously has been zoned R-E  
9 (County of Clark classification), is hereby classified as U (RNP) (City of Las Vegas  
10 classification), which is deemed to be the City equivalent of the County classification.

11 SECTION 8: If any section, subsection, subdivision, paragraph, sentence,  
12 clause of phrase in this ordinance or any part thereof, is for any reason held to be  
13 unconstitutional, or invalid or ineffective by any court of competent jurisdiction, such  
14 decision shall not affect the validity or effectiveness of the remaining portions of this  
15 ordinance or any part thereof. The City Council of the City of Las Vegas hereby declares that  
16 it would have passed each section, subsection, subdivision, paragraph, sentence, clause or  
17 phrase thereof irrespective of the fact that any one or more sections, subsections,  
18 subdivisions, paragraphs, sentences, clauses or phrases be declared unconstitutional, invalid  
19 or ineffective.

20 ...  
21 ...  
22 ...  
23 ...  
24 ...  
25 ...  
26 ...  
27 ...  
28 ...

1  
2  
3  
4  
5  
6  
7  
8  
9  
10  
11  
12  
13  
14  
15  
16  
17  
18  
19  
20  
21  
22  
23  
24  
25  
26  
27  
28

SECTION 9: All ordinances or parts of ordinances, sections, subsections, phrases, sentences, clauses or paragraphs contained in the Municipal Code of the City of Las Vegas, Nevada, 1983 Edition, in conflict herewith are hereby repealed.

PASSED, ADOPTED and APPROVED this \_\_\_\_\_ day of \_\_\_\_\_, 2006.

APPROVED:

By OSCAR B. GOODMAN, Mayor

ATTEST:

BARBARA JO RONEMUS, City Clerk

APPROVED AS TO FORM:  
Val Heed 3-1-06  
Date

1 The above and foregoing ordinance was first proposed and read by title to the Council on the  
2 \_\_\_\_ day of \_\_\_\_\_, 2006, and referred to the following committee  
3 composed of \_\_\_\_\_ and \_\_\_\_\_ for recommendation;  
4 thereafter the said committee reported favorably on said ordinance on the \_\_\_\_ day of  
5 \_\_\_\_\_, 2006, which was a \_\_\_\_\_ meeting of said Council; that  
6 at said \_\_\_\_\_ meeting, the proposed ordinance was read by title to the City  
7 Council as first introduced and adopted by the following vote:

8 VOTING "AYE": \_\_\_\_\_

9 VOTING "NAY": \_\_\_\_\_

10 ABSENT: \_\_\_\_\_

11 APPROVED:

12  
13 By OSCAR B. GOODMAN, Mayor

14 ATTEST:

15  
16 BARBARA JO RONEMUS, City Clerk  
17  
18  
19  
20  
21  
22  
23  
24  
25  
26  
27  
28

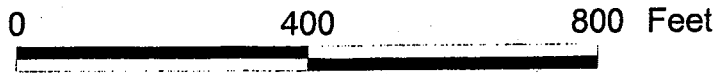
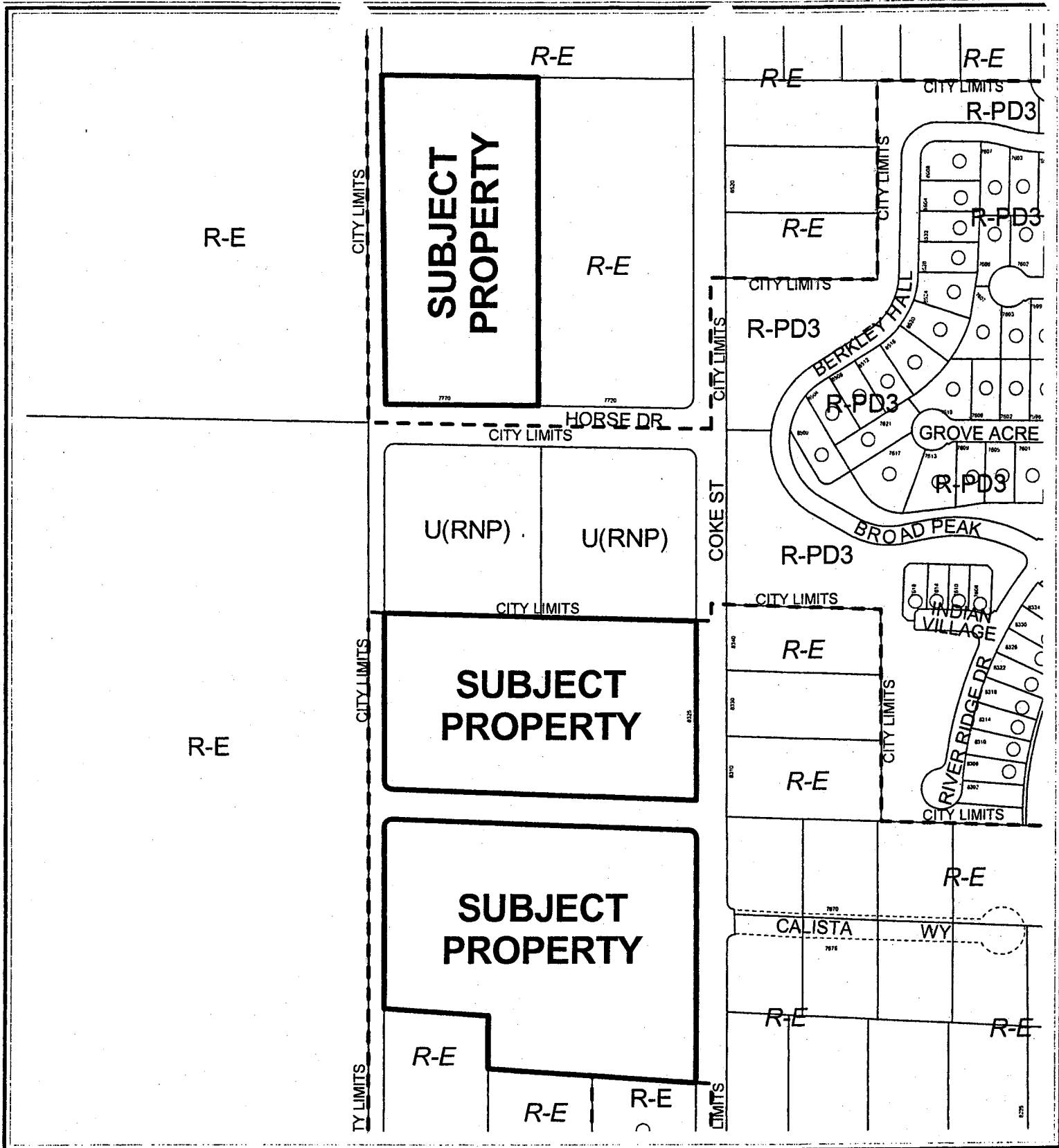

CASE: ANX-11001

